

## Installation instruction

### Remote switch three button



The Mymesh remote switch three button is part of the Mymesh Building Light Control product suite for wireless lighting control. The remote switch is a wireless on/off, dimming or scene switch with a battery for flexible wall/ceiling mounting. The remote switch enables you to switch on/off the lights, step less dim the light or select a scene for lighting fixtures equipped with Mymesh light control.

#### Safety



- Installation and service should be performed by qualified personnel only.
- Do not use the remote switch if it is damaged.
- This product contains a **non-replaceable** and **non-rechargeable** Lithium battery
- The remote switch is suitable for use at indoor and covered outdoor locations (IP54 protection class).

#### Application

Refer to the remote switch product sheet (see [chess.nl](http://chess.nl)) for the product specifications and environmental conditions.

## Location

Locate the remote switch in the direct neighborhood of other Mymesh products. Mount the remote switch on a wall or table. Avoid positions vulnerable for mechanical impact (e.g. by transport carts).

## Installation

- The remote switch contains an (internal) antenna for wireless communication with other Mymesh products. Operation of the antenna should not be disrupted.
  - Do not mount the remote switch inside a metal housing or directly next to a large metal object.
  - Some glass and plastic materials influence the operation of an antenna.
  - Contact Chess in case of doubt.
- Attach the mounting plate with at least 2 screws or double-sided adhesive tape to a wall or table.
- Insert the remote switch at one side in the mounting plate and push the remote switch until it locks.
- Attention! Make sure the screws do not poke out too far, otherwise the switch can be placed under mechanical stress. This can result in one of the buttons being continuously being pressed, resulting negative effects for the battery.

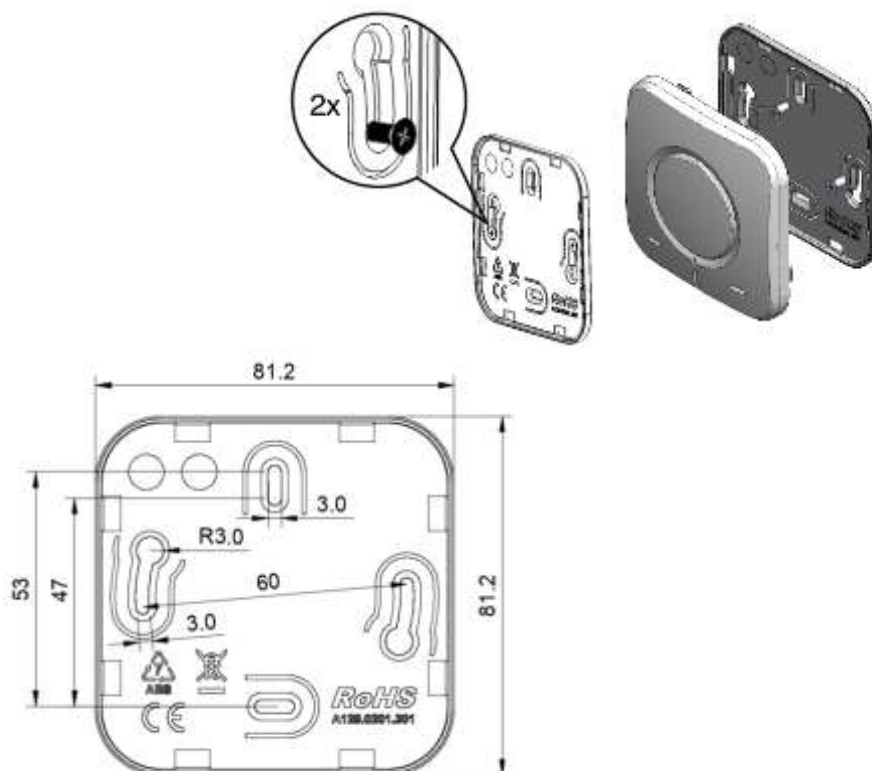

## Mounting panel dimensions

## Configuration

Use the iPad Mymesh commissioning app for configuration of the remote switch. Enable *commission mode* by operation of both the left and right switch until 3 beeps are given.

After pushing of one of the buttons or 60 sec the remote switch will go to *normal mode* again.

When a remote switch is commissioned for the first time, commission mode can be reached by operation of both the left and right switch until 2 and 3 beeps are given and next both buttons are released within 5 sec. Commissioning of the remote switch is now possible.

The remote switch is standard configured as dimming switch.

## Usage

After commissioning with the iPad the remote switch will return to *normal mode* and operates autonomous in the Mymesh network.

## Compliance



This product complies with the European directives and relevant standards for low voltage, EMC, RED, REACH and RoHS. The remote switch contains a 2.4 Ghz radio. The applied frequency of the radio is within the band 2.401 – 2.483 GHz and the maximum transmit power is +4 dBm.

Hereby, Chess Wise declares that the radio equipment type remote switch is in compliance with Directive 2014/53/EU. The full text of the EU declaration of conformity is available at [chess.nl](http://chess.nl)

## Repair

Do not open this product. In case of failure or empty battery the remote switch must be replaced.



## Recycling

Do not dispose this product as household waste, but bring it to an appropriate collection point for recycling.